



Stoneacre
Properties



Citispace, Leeds, LS2 7JQ
Offers Over £50,000

*** LARGE ONE BEDROOM FLAT CLOSE TO LEEDS CITY CENTRE! *** Offering for sale a compact yet well planned apartment located on the first floor of an attractive purpose built block of flats close to Leeds City Centre and within easy reach of shopping and transport amenities. The property is a larger one bedroom flat in the development the property comprises, reception room/kitchen, bedroom, shower room and is sure to be popular! The apartment is currently let out at £575 PCM.

COMMUNAL ENTRANCE

Secure entry system with lift leading up to all floors.

LIVING AREA/KITCHEN/DINER

Wood strip laminate flooring, wall mounted electric heater, double glazed floor to ceiling windows with sliding door and Juliette balcony. Kitchenette comprising stainless steel sink, two ring electric hob, oven and space for fridge.

BEDROOM

Wood strip laminate flooring, built in open wardrobe.

BATHROOM

Shower room comprising W.C, hand wash basin and shower cubicle.

LEASE

We are advised by the vendor that the property is leasehold with a term of approximately 104 years remaining. The current service charge is approximately £1788 per annum (paid half yearly) and the ground rent is £150 per annum. A buyer is advised to obtain verification from their solicitor or legal advisor.

Floor Plan

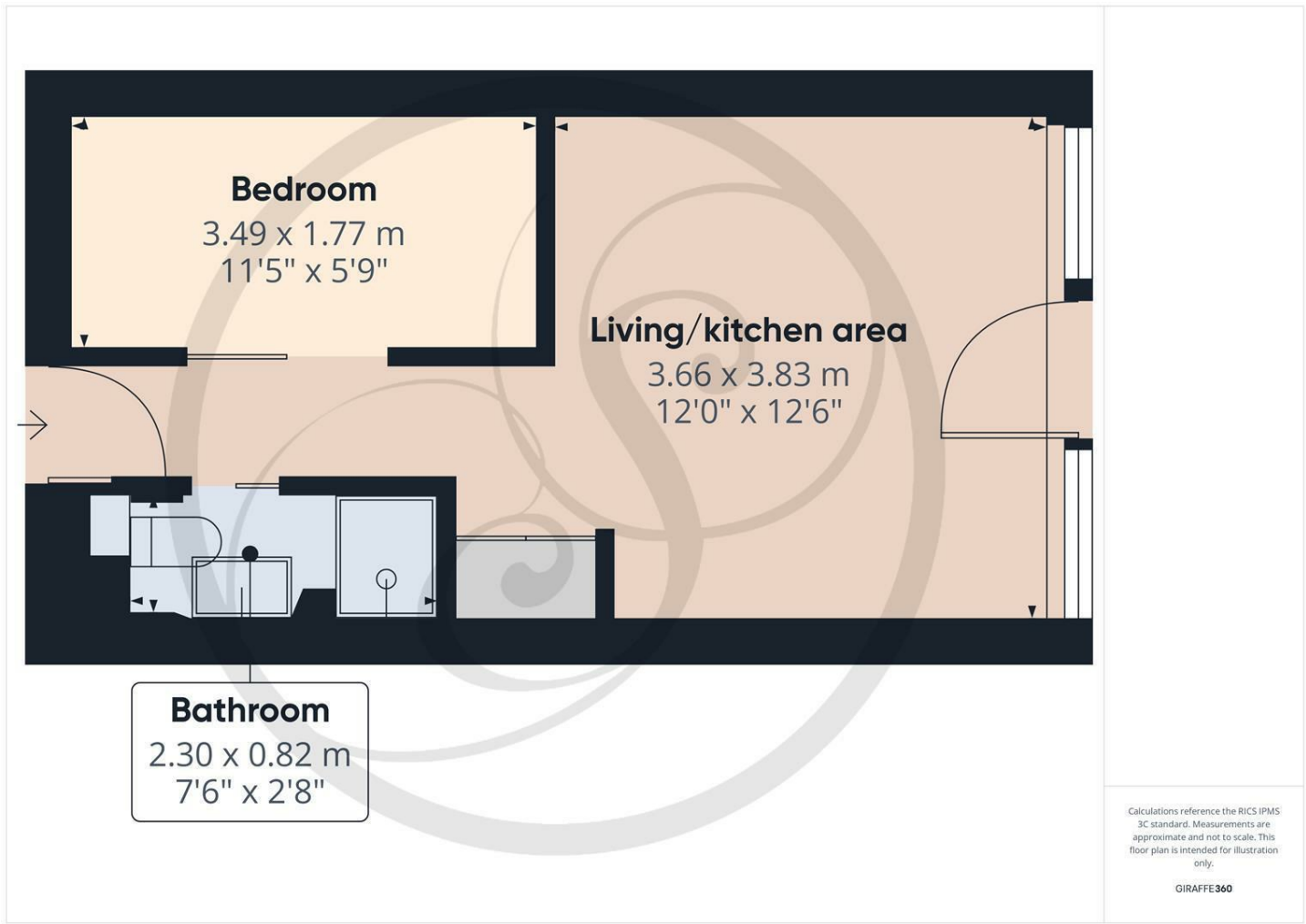

Area Map

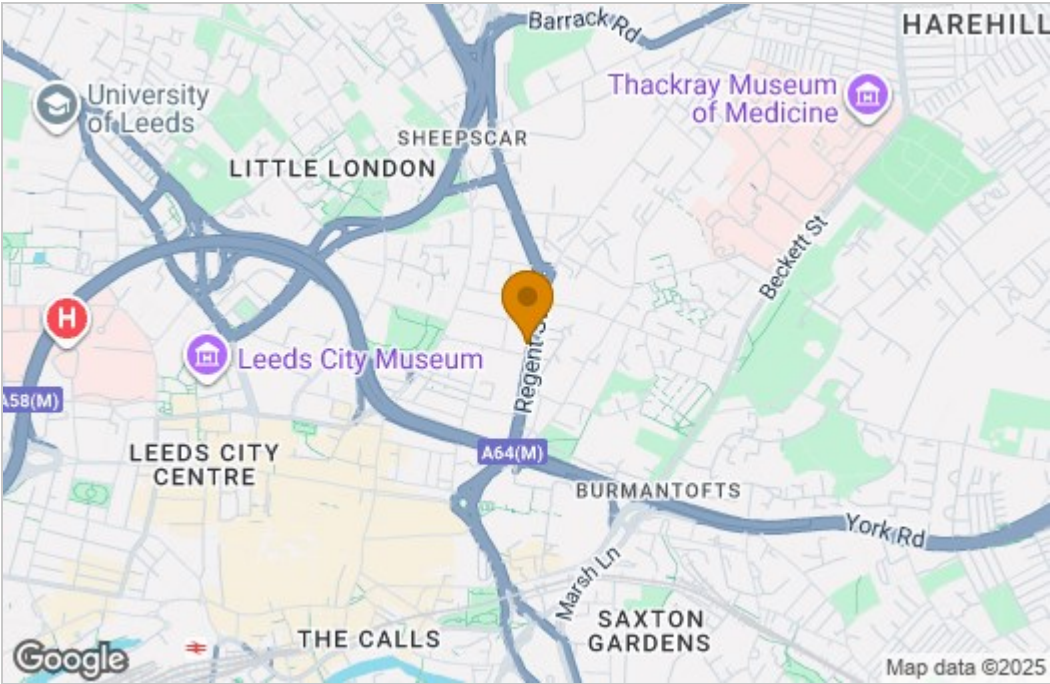

Energy Efficiency Graph

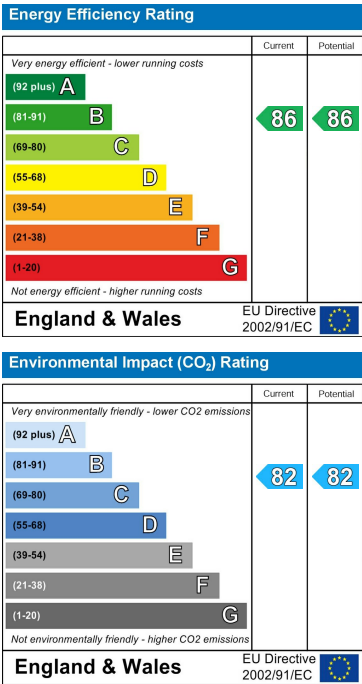

These particulars, whilst believed to be accurate are set out as a general outline only for guidance and do not constitute any part of an offer or contract. Intending purchasers should not rely on them as statements of representation of fact, but must satisfy themselves by inspection or otherwise as to their accuracy. No person in this firm's employment has the authority to make or give any representation or warranty in respect of the property.

